



# THEME PARKS & ACCESSORIES



# Yellow Banana



3

About us



6

Liliputia - Play houses



15

Tiny transportation

16

Cars



21

Trucks



23

Tractors



24

Boats



25

*CONSTRUCTION ZONE*



30

Kiki



# About us



Our company offers a turnkey solution within the framework of the **Children's Capital project**.

Complete small town construction, construction zone, driving school, boating school and other modules together.

**For over two decades, we have passionately dedicated ourselves to teaching and entertaining children.**

We understand the importance of nurturing laughter and creating cherished memories. That's why we have meticulously designed a captivating line of playhouses that will ignite your child's creativity and bring endless joy to their world.

We are present on the Slovakian, Czech and Hungarian market and we are planning to extend all around Europe soon.

Contact us and let's plan the children's capital together!



## OUR PARTNERS

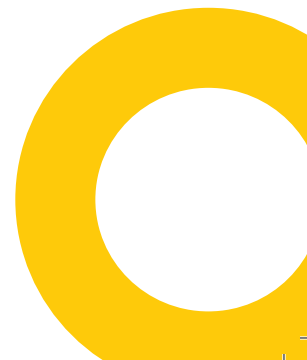

# Plan for success

## MASTER PLAN

We need to start with the question; What do you want to achieve? We like to understand your situation to make sure we are optimizing our attractions according to your plan. This plan normally includes your Vision & Goals, Location & Premises, Targets & Target Customers, Theme & Customization, Financing & Budget. The outcome is a clearer understanding of the project making it easier to communicate with stakeholders which in turn leads to greater success.

## REVENUE STREAMS

We want to make sure that your investment in our attractions really pay off. We can assist with calculation of ROI based on Capacity/THRC and do Scenario planning and What-If analyses. This will give you better control and a safer investment.

## DESIGN AND PLAN

Obviously, we have loads of experience of how to design and plan the design and setup of our attractions. Each situation is unique and we like to discuss the available area, number of visitors, flow of people etc. Based on this we can create a visualization of the attraction and also make sure you will get the optimal type of rides as well as the right amount of units.

## IMPLEMENTATION

When it comes to executing the plan, we can use our experience from planning hundreds of projects and assist to make this part a smoother process for you. We like to share our experience and on some markets we even offer turn-key solutions where we take care of the whole implementation. The goal is to shorten the set-up time and to avoid mistakes and unpleasant surprises.

## DAILY OPERATIONS

Once you have everything set-up we want you to make the most out of your SBI rides. Again, based on experience from hundreds of different operations around world we can assist in fine-tuning your daily operation to make sure you have a well-functioning and smooth operation with the right focus and right allocation of resources. Please get in touch! We look forward to discussing your specific project with you!

When designing and planning your park/attraction there is a lot to take into account.

**At YELLOW BANANA we have more than 20 years of experience from the industry.** We like to use this experience to assist our customers to get the most out of the rides. There are many aspects to take into account and to the right are some examples of where we love to be involved.



# Example layout - Large



**Large example layout**  
Area required - 2 500 m<sup>2</sup>

- 1 Liliputia - play houses**  
Minimum houses recommended 20 pcs.
- 2 Children's driving school**  
Minimum cars recommended 25 pcs.
- 3 Construction zone**  
4 Mini Tower Cranes  
4 Mini Diggers  
4 Mini Grabbers
- 4 Children's farm**  
Minimum tractors recommended 15 pcs.
- 5 Playground**

# Lilliputia



**Our company offers a turnkey solution within the framework of the Children's Capital project. Complete small town construction, construction zone, driving school, boating school and other modules together.**

For over two decades, we have passionately dedicated ourselves to teaching and entertaining children. Today, we are thrilled to introduce our **new brand, LILLIPUTIA**, as the ultimate destination for imaginative play.

In LILLIPUTIA, we understand the importance of nurturing laughter and creating cherished memories. That's why we have meticulously designed a captivating line of playhouses that will ignite your child's creativity and bring endless joy to their world.

**Our main product line focuses on providing enchanting playhouses for business environments.** Whether you own a daycare, preschool, or any child-centric establishment, LILLIPUTIA offers the perfect solution to enhance the play experience and create a magical atmosphere for young imaginations to thrive.

Additionally, we also offer a wide range of indoor playhouses for your home, allowing your child to continue the adventure of imaginative play in a cozy and safe environment.

Explore the captivating pictures that will inspire you to bring the magic of LILLIPUTIA to your business or home. Sign up for updates and be the first to know when our delightful products become available.

Experience the magic of LILLIPUTIA, the Capital City of Children, where every moment is filled with wonder, laughter, and extraordinary play experiences for the extraordinary children in your life.

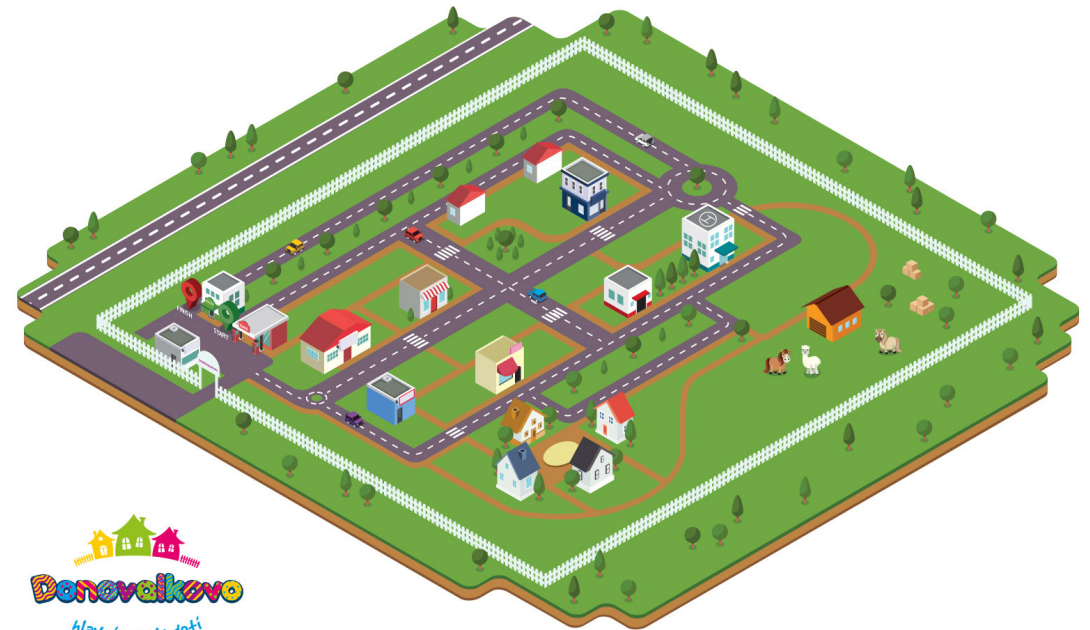

# Lilliputia - Play houses



# Lilliputia - Play houses



# Lilliputia - Christmas city



Scan  
for the video

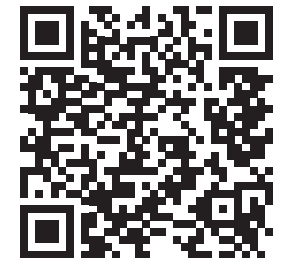

# Lilliputia - Play houses



## Art Gallery



Any vibrant downtown community would welcome this picturesque Art Studio. Designed to resemble a converted storefront, complete with a large bay window and second-story window boxes brimming with flowers, this play house can be a welcome place to craft and create. The walls are ready to display the works of famous artists, or little budding ones creating their own masterpieces. Art builds confidence, sparks imagination and is plain Fun!

### Features

- Drawing Easel
- Artwork Wall Display
- Vinyl Hardwood Floor
- Flower Box
- Flowers
- Custom Signage

### Colors

- Hearts of Palm
- Heron Plume
- Rave Red

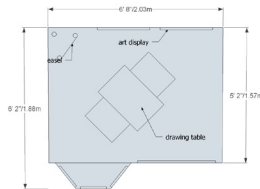

**Dimensions**  
203 x 188 x 287 cm



### Options

- Table & Chair Set
- Increase Playhouse Size
- Custom Paint Selection
- Exterior Conversion
- Kid's Play Furniture

## Restaurant Dinner



Decisions, decisions... so many roles to play! Do I want to be the customer placing my order, the waiter/waitress taking their order, the chef flipping the burgers, or the cashier in charge of the money? This time, I think I'd rather be the customer pulling up to the drive-through window in my car. "I'll have a burger and an order of fries, please!" No matter what role you choose, the Main Street Diner is bound to provide hours of laughter and fun for all.

### Features

- Front Counter with Grill
- Rear Counter
- Safety Mirror
- Drive-up Window
- Wall & Drive-up Menus
- Checkerboard Flooring
- Custom Signage

### Options

- Faux Food
- Customized Aprons
- Red Leather Booth & Table
- Cash Register
- Leather Stools
- Diner Merchandise Package
- Increase Playhouse Size
- Custom Paint Selection
- Exterior Conversion
- Kid's Play Furniture

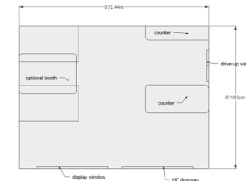

**Dimensions**  
244 x 183 x 213 cm



## Grocery Market



What child doesn't love pushing a shopping cart around the store, tossing in all sorts of food and produce items? This turn-of-the-century charmer, complete with awnings, is guaranteed to be the busiest place in town. Equipped with a checkout counter, produce bin, and merchandise shelves, the Grocery Market along Main Street is a classic in every way. Optional Delivery Truck, provides a fun, activity-related accessory.

### Features

- Counter
- Pickle Barrel
- Produce Display Stand
- Shelving (2)
- Custom Signage

### Colors

- Lemon Chiffon
- Extra White
- Shamrock Green
- Fireweed Red

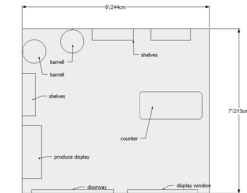

**Dimensions**  
244 x 213 x 280 cm



### Options

- Pot-bellied Stove
- Grocery Merchandise Package
- Cash Register
- Customized Aprons
- Commercial Shopping Cart
- Scanning Check-Out Counter
- Increase Playhouse Size
- Custom Paint Selection
- Exterior Conversion
- Kid's Play Furniture

# Lilliputia - Play houses



## Hospital



This charming Hospital with clapboard siding and large flower box, serves as the ideal place for quick check-ups or emergency visits. Equipped with eye and skeletal charts and its very own defibrillator, aspiring young physicians can make the right diagnosis with confidence in this adorable playhouse. Or upgrade to our Hospital with drive-through Emergency Room for added activity-related fun.

### Features

- Flower Box
- Exam Table
- Eye Chart
- Skeletal Chart
- Defibrillator
- Diploma
- Flowers
- Medicine Cabinet
- Custom Signage

### Colors

- Extra White
- Fireweed Red

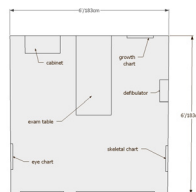

### Dimensions

183 x 183 x 266 cm



### Options

- Surgery Table
- Furniture
- Increase Playhouse Size
- Custom Paint Selection
- Exterior Conversion

## Post office



Who doesn't love getting mail? Now, children can role play mailing their letters at our Post Office Playhouse with our interactive mailbox, sorting it in our old-fashioned pigeon-holed letter cabinet, and delivering it. That means fun no matter what role you play!

### Features

- Interactive Mailbox
- Pigeon-hole Letter Sorting Cabinet
- Custom Signage



### Dimensions

152 x 152 x 180 cm



### Options

- Kid's Play Furniture

## Theater



Whether you have a budding Brando or Garbo, the Main Street Theater is sure to get a standing ovation. An Art Deco exterior features a ticket window with faux glass block, and a lighted changeable marquee where you can announce today's feature presentation. Inside you will find a hand-painted accent floor and theater bench seating.

Add a flat screen TV to make this little movie house an Oscar winning delight! We can also add an optional sidewalk impression of your "little stars" handprints and signature, or a stage for live performances!

### Features

- Lighted Marquee
- Ticket Window
- Lighted Marquee with Changeable letters
- Theater Seating

### Colors

- Canvas Tan
- Sandy Ridge
- Naval
- Positive Red
- Golden Rule

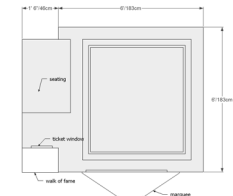

### Dimensions

183 x 183 x 243 cm



### Options

- Kid's Play Furniture
- Theming
- Personalized "walk of fame" sidewalk
- Stage

# Lilliputia - Play houses



## Beauty Salon



This stucco-finished Beauty Boutique along Main Street is as precious as they come. Complete with retro styling, this adorable playhouse makes a great place for dress-up and make-believe runway modeling. Whether you are sitting in the child-sized salon chair, playing the role of beautician, or dressing up to strut on the runway, this playhouse inspires the fashionista in everyone!



### Features

- Counter
- Safety Mirror
- Hairstyle Mirror
- Flower Box
- Flowers
- Custom Signage

### Options

- Salon Chair
- Play Salon Equipment
- Increase Playhouse Size
- Custom Paint Selection
- Exterior Conversion
- Kid's Play Furniture

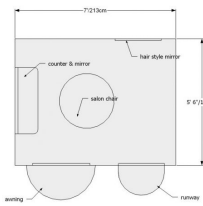

### Dimensions

213 x 160 x 180 cm

## Fairytale Cottage



Enchantingly decorated, Fairytale Cottage is the perfect playhouse for your young princess. From the cedar shingles and simulated-stone chimney on the outside to the stenciling and fireplace on the inside, the Fairytale cottage is the ideal setting for an afternoon tea party in the woods. This charming play house is designed in a traditional timber-framed Tudor style with wattle and daub fashioned construction. Cut-out heart details embellish the iron-hinged front door and the wooden shutters which frame the operable windows. Imagine your princess playing in her kitchen, sweeping the hardwood floors, or climbing up in her loft to read or take a nap. Entertaining her fellow princes and princesses in this adorable playhouse will make every day unforgettable.

### Features

- Loft
- Hardwood Floor
- Fireplace and Mantle

### Options

- Kid's Play Furniture
- Enlarge your playhouse, choose your own colors & more!



### Dimensions

213 x 183 cm

## Cotton Candy Manor



Sugar and spice and everything nice, that's what this manor is made of! Clad in cotton-candy color siding, this sweet estate will entertain its wee occupants for hours. Built in a traditional style, the front entrance is created with a custom styled front door topped with a sunburst transom window, protected by a peaked roof line. This home's rich features include dormers, a wing surrounded by elegant palladian windows, a side entrance door with window, and slate grey window shutters which accent the operable windows. A brass plated doorbell and door knocker are perfect for announcing visitors to this delightful home. Inside, a loft leads to an outdoor balcony, while the columned porch below creates a shady spot for reading or resting. Once featured on the Oprah Winfrey Show, delectable details inside this home include textured-painted walls, simulated hardwood floors, and a sunny skylight.

### Features

- Loft
- Textured Interior Painting
- Faux Hardwood Floors
- Doorbell
- Skylight
- Door Knocker

### Options

- Kid's Play Furniture
- Enlarge your playhouse, choose your own colors & more



### Dimensions

457 x 182 x 294 cm

# Lilliputia - Play houses



## Barn



This classic red and white farm house will help to bring out the budding farmer or aspiring equestrian in every child! Custom signage above the doorway makes for a grand entrance to your very own farm and the double doors will allow for easy accessibility, no matter how big the cattle are. The six operational windows on the front and sides of the house bring plenty of sunlight and fresh open air into the 8' by 10' structure. Children will have a field day playing in and out of the farm and will be immersed in imagination by the realistic shake shingle roofing, durable cedar plank flooring, and a soaring cupula so beautiful it would even make Old MacDonal'd jealous!

### Features

- Faux Stone Foundation
- Shake Shingle Roof
- Board and Batten Siding
- Cupula
- Faux Planking Interior Walls
- Cedar Plank Flooring
- Custom Signage

### Options

- Egg Roll
- Horse Tail Braiding
- Riding Horse
- Garden
- Photo Board
- PVC Hay Bales
- Mailbox
- Increase Playhouse Size
- Custom Paint Selection
- Exterior Conversion
- Kid's Play Furniture
- Theming

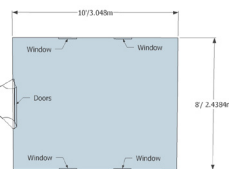

**Dimensions**  
305 x 243 x 280 cm



## Police Station



Every town has its fair share of bad guys! You need someplace for the police officers to fingerprint them and lock 'em up! This faux brick Main Street Police Station Playhouse is topped with an scalloped cornice and "Precinct" sign and also includes two decorative ball faux lights as well as a pretend pull alarm. The station features a counter, customizable "Wanted" sign, and its very own jail, making it one of our most adorable kids play houses.

### Features

- Escape Tunnel to Bank
- Activity Panel
- Uniforms
- Increase Playhouse Size
- Custom Paint Selection
- Exterior Conversion
- Kid's Play Furniture
- Theming

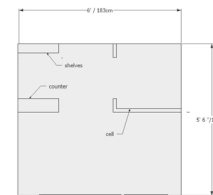

**Dimensions**  
183 x 168 x 200 cm



## Service Station



Boys and girls alike will love spending hours playing inside this 50's styled Main Street Service Station. From pumping gas at the realistic-looking pump to checking beneath the car on the lift, this activity-related playhouse brings out the mechanic in all of us. Write up orders at the checkout counter or check your tires at the Air Station. No matter what you do, fun is guaranteed in this fantastic playhouse!

### Features

- Gas pump
- Counter
- Tires Rack
- Air Station
- Grease Barrel
- Work Bench & Tool Peg Board



### Options

- Tools
- Increase Playhouse Size
- Custom Paint Selection
- Exterior Conversion
- Kid's Play Furniture



**Dimensions**  
340 x 170 x 234 cm



# Projects - Visualisation

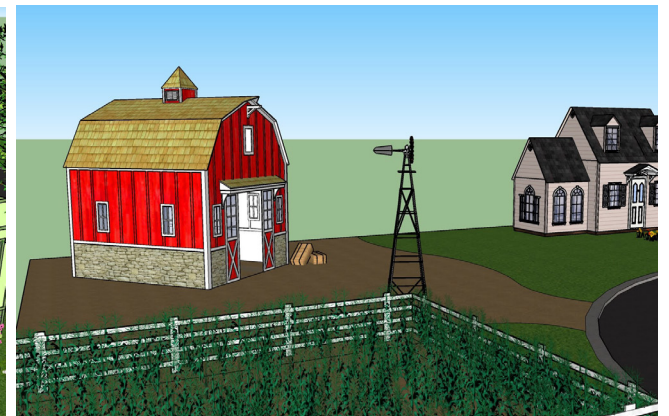

# Tiny transportation



**This attraction is based on the creation of a miniature traffic environment in which children gain knowledge of traffic safety as well as improve their driving skills.**

The educators provide kids with information about basic traffic safety, and once at the track, the children practice what they learned. After successful completion of the training, the participants may eventually obtain their driver's license! Edutainment exemplified!

Our Children Driving Schools can range from minimalistic tracks with essential equipment to custom-designed concepts inspired by a particular theme. Yellow Banana provides its clients with all the necessary supplies, from one single car to the whole fleet of vehicles, traffic signs, and traffic light systems. Our 12 and 24-volt battery cars and trucks are available in many appealing designs to choose from.

To achieve greater authenticity, some of our clients go one step further, and add a car washing tunnel or a charging station, so that kids feel like real drivers. Pretty cool, don't you think? And, since imagination knows no bounds, what about a fire station or an entire city?

The driving school is a timeless attraction that can be installed at large or small amusement parks as well as at other kinds of facilities.

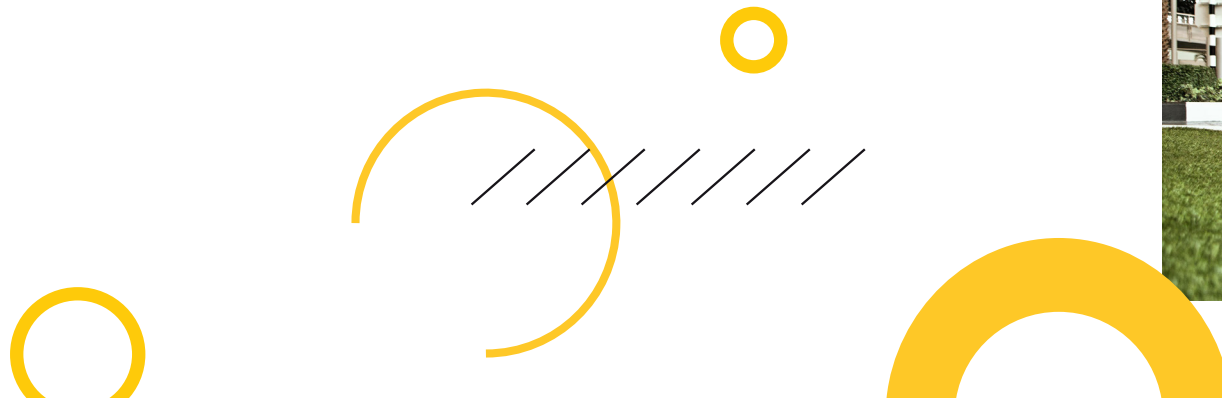

# Cars

## STANDARD VEHICLES

12 V System. Fixed speed. External bumpers.



### TECHNICAL SPECIFICATIONS

**Capacity:** 1 child

**Age range:** 3 to 11 years old.

**Maximum weight admitted:** 50 kg (110 lb).

**Speed max:** 4 km/h.

**Frame:** Reinforced steel tubing, powder coated.

**Body:** Hand-laid GRP. 3-layer gelcoat, 3-layer mat and reinforced by laminate.

**Bumpers:** Molded vulcanized rubber with steel reinforcement.

**Transmission:** Timing belt.

**Wheels:** Rubber tire with inner tube. (10").

Ball Bearing in each rim.

**Electrical system:** 12 V.

**Motor:** Electric motor with planetary gearing.

**Motor fuse:** Automatic 12 V 10 A, 5 - 10 sec o, 10-20 sec. reset.

**Battery:** Dry fit traction block (12 V - 38 Ah).

**Weight:** approx. 10 kg.

**Operating time:** 8 - 10 hours.

**Battery charger:** 3-step charger (12 V - 4 A), fully automatic.

**Accelerator:** Pedal (green), with micro switch.

**Brake:** Automatic.

### Shipping parameters:

1 unit 153 x 80 x 90 cm, cca 80 kg.

2 units 153 x 80 x 145 cm, cca 140 kg.

3 units 153 x 80 x 210 cm, cca 210 kg.

### DECOR

Flames

Flower

Police, EU

Police, US

Rally

Custom decors on request

### COLOR

Red

Orange

Yellow

Pink

Green

Blue

White

Black

Custom colors on request

### OPTIONS

Sound

Light

Safety belt

Remote control

Coin / token

Kindly take note that the measurements provided are approximate. The current models available may differ from the pictures exhibited. The color reproduction of images may differ from reality. Therefore, we encourage you to confirm the particularities of the product of your interest.

# Cars

## Buggie

**Measurement:**

108,5 (l) x 60 (w) x 60 (h) cm

**Weight:**

55 kg approx. (incl. batteries)



## Beetle

**Measurement:**

153 (l) x 70 (w) x 60 (h) cm

**Weight:**

63 kg approx. (incl. batteries)



# Cars

## Pento

**Measurement:**  
153 (l) x 70 (w) x 60 (h) cm

**Weight:**  
63 kg approx. (incl. batteries)



## Vento

**Measurement:**  
153 (l) x 70 (w) x 60 (h) cm

**Weight:**  
63 kg approx. (incl. batteries)



# Cars

## Sensa

**Measurement:**  
153 (l) x 70 (w) x 60 (h) cm

**Weight:**  
63 kg approx. (incl. batteries)



## Monza

**Measurement:**  
153 (l) x 70 (w) x 60 (h) cm

**Weight:**  
63 kg approx. (incl. batteries)





# Trucks

## Volvo FH16

**Measurement:**  
150 (l) x 70 (w) x 60 (h) cm

**Weight:**  
68 kg approx. (incl. batteries)



## Volvo FH16 Truck with Trailer

**Measurement:**  
280 (l) x 71 (w) x 60 (h) cm

**Weight:**  
90 kg approx. (incl. batteries)



## Volvo FH16 Tow Truck

**Measurement:**  
150 (l) x 71 (w) x 60 (h) cm

**Weight:**  
71 kg approx. (incl. batteries)



# Trucks

## Fire Trucks & Friends

**Measurement:**  
150 (l) x 57 (w) x 70 (h) cm

**Weight:**  
68 kg approx. (incl. batteries)



# Tractors

## SBI Tractor

### Measurement:

122 (l) x 60 (w) x 65 (h) cm

### Weight:

70 kg approx. (incl. batteries)



## SBI TRACTOR

12 V System. Durable authentic design.

### TECHNICAL SPECIFICATIONS

**Capacity:** 1 child

**Age range:** 3 to 11 years old.

**Maximum weight admitted:** 50 kg (110 lb).

**Speed max:** 4 km/h.

**Frame:** Reinforced steel tubing, powder coated.

**Body:** RTM Fiberglass.

**Bumpers:** Molded vulcanized rubber with steel reinforcement.

**Transmission:** Chain.

**Wheels:** Rubber tire with inner tube. (10" and 17").

Ball Bearing in each rim.

**Electrical system:** 12 V.

**Motor:** Electric motor with planetary gearing.

**Motor fuse:** Automatic 12 V 10 A, 5 - 10 sec o, 10-20 sec. reset.

**Battery:** Dry fit traction block (12 V - 38 Ah).

**Weight:** approx. 10 kg.

**Operating time:** 8 - 10 hours.

**Battery charger:** 3-step charger (12 V - 4 A), fully automatic.

**Accelerator:** Pedal (green), with micro switch.

**Brake:** Automatic.

### Shipping parameters:

1 unit 122 x 80 x 85 cm, cca 97 kg.

2 units 122 x 80 x 170 cm, cca 165 kg.

3 units 122 x 80 x 215 cm, cca 240 kg.

### DECOR

Custom decors on request

### COLOR

Red

Orange

Green

Blue

Custom colors on request

### OPTIONS

Sound

Light

Remote control

Coin / token

Kindly take note that the measurements provided are approximate. The current models available may differ from the pictures exhibited. The color reproduction of images may differ from reality. Therefore, we encourage you to confirm the particularities of the product of your interest.

# Boats

## SBI Boat

### Measurement:

275 (l) x 154,5 (w) x 95,5 (h) cm

### Weight:

287 kg approx. (incl. batteries)



## SBI BOAT

24 V System. Smoothy sturdy ride. High capacity up to 3 persons.

### TECHNICAL SPECIFICATIONS

**Capacity:** 2 adults or 1 adult and 2 kids.

**Age range:** 3 and up.

**Maximum weight admitted:** 180 kg (400 lb).

**Speed max:** 3 km/h (programmable +/- 10%).

**Hull / Deck:** Hand-laid GRP, 2 layers gelcoat, 3 layers mat, and reinforced by laminate. Non-slip surface on seats and floor.

**Bumpers:** Rubber front, side, and rear fenders.

**Height over Water Line:** 0,55 m.

**Water depth:** Minimum 0,6 m.

**Turning diameter:** 10,0 m.

**Electrical system:** 24 V.

**Motor:** Electric, sealed under-water motor. Purpose built for both propulsion and steering action.

**Motor controller:** Fully automatic.

**Bilge pump:** Fully automatic.

**Battery:** 4 x Gel Type VRLA 6 V 180 Ah.

**Weight:** approx. 30 kg/each.

**Operating time:** 8 - 10 hours.

**Battery charger:** 3-step charger (24 V - 20 A), fully automatic.

**Accelerator:** Air pedal with pressure switch.

**Navigation:** LED lights.

**Steering:** Heavy Duty Hydraulic Steering System.

### Shipping parameters:

1 unit 275 x 165 x 140 cm, cca 320 kg.

2 units 275 x 165 x 210 cm, cca 620 kg.

### DECOR

Custom decors on request

### COLOR

Red

Yellow

Orange

Blue

Custom colors on request

Kindly take note that the measurements provided are approximate. The current models available may differ from the pictures exhibited. The color reproduction of images may differ from reality. Therefore, we encourage you to confirm the particularities of the product of your interest.

# CONSTRUCTION ZONE



With their realistic appearance, our construction-themed products always trigger the desire to play, explore and learn. **True educational attractions that kids love because they are fun, but also may trigger interest in engineering and machinery.**

Not only kids but also adults and machinery fans may be unable to resist the temptation to get closer and check them out. Our building zone products are certainly true attention grabbers!

**The three products can be combined in one play area to create a building zone where kids can role-play as construction professionals or simply enjoy the fine mechanics that these machines present.** The youngest ones will learn physical skills and movement while having a blast digging holes in the ground or skillfully moving blocks around. Parents or siblings can easily assist if needed.

Unlike our other products, both the Mini Digger, Mini Grabber, and Mini Tower Crane are stationary, which represents a space-saving solution. These are attractions that kids love and that can be placed in also small areas. Positioned where the is a flow of people will no doubt create not only a very popular play area but also generate good revenue.

These products have been delivered globally to a wide range of indoor and outdoor facilities where they quickly become a favorite attraction! Examples of venues are theme parks, fairgrounds, farm parks, zoos, science centers, campsites, hotels, and shopping centers.

These machines are available for sale or for comissional rent.

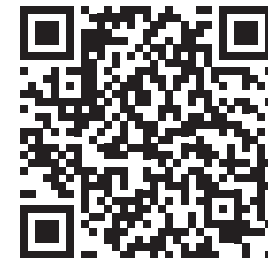

# MINI DIGGER & MINI GRABBER

## MINI GRABBER & MINI DIGGER

Hydraulically operated for an authentic experience. Stationary, thus space efficient.

### TECHNICAL SPECIFICATIONS

**Capacity:** 1 child.

**Age to operate:** From 3 years (under adult supervision).

**Maximum weight admitted:** 80 kg (180 lb).

**Body:** Steel, powder coated.

**Seat:** RTM fiberglass.

**Maximum noise:** 65 dB.

**Timer:** Adjustable, 3 or 5 minutes.

**Turning angle of arm:** 90°.

**Recommended digging depth:** 40 cm from digger base.  
(Version with lower digging depth for indoor use available.)

**Electrical system:** 230 VAC / 24 VDC

**Hydraulically operated:** 3 cylinders, a hydraulic control valve and oil pump system.

**Lever to operate:**

- Left lever: Boom (push/pull).
- Middle lever: Shovel (push/pull).
- Right lever: Arm (push/pull).

**Max amount of load in shovel:** 3 liters (approx.).

**Oil pump:** Pump is set at 20 bar and must not be increased for safety reasons.

**Operating system:** Coin/token mechanical coin acceptor or free play button. Card payment or electronic multicoin acceptor as option.

**Security:** To be installed with fence around digging area.

**Shipping parameters:**

1 unit 220 x 85 x 125 cm, 155 kg.

2 units 220 x 85 x 210cm, 275 kg.

### COLOR

Yellow

Black

### OPTIONS

Coin / Token

Card Reader

Kindly take note that the measurements provided are approximate. The current models available may differ from the pictures exhibited. The color reproduction of images may differ from reality. Therefore, we encourage you to confirm the particularities of the product of your interest.

## Mini Grabber & Mini Digger

**Measurement:**  
240 (l) x 76 (w) platform x 100 (h) cm

**Weight:**  
92 kg



# MINI TOWER CRANE

## MINI TOWER CRANE

Electromagnet. Operated with joysticks.

### TECHNICAL SPECIFICATIONS

**Capacity:** 1 child.

**Age to operate:** From 3 years (under adult supervision).

**Maximum weight admitted:** 80 kg (180 lb).

**Operating system:** Coin mechanism (mechanical) or Push Button. Prewired for electronic coin acceptor or card payment system.

**Turning angle of boom:** 60°.

Custom changes available.

**Height of magnet:** 120 cm from floor. (adjustable)

**Electrical system:** Input 85-264 VAC. Operational 24 VDC, 60 W.

**Fuse:** Power supply internal protections. short circuit/overload over voltage. External, 2 A fuse.

**Timer:** Adjustable to 3 or 5 minutes.

**Motors:** 3 x 24 V DC motors.

**Electromagnet:** Max capacity 1 kg (approx).

**Joysticks to Operate:**

**Right Joystick:** Left/Right, Forward/Backward.

**Left joystick:** Up/Down. Release.

**Body:** Powder coated steel.

**Shipping parameters:**

1 unit 120 x 80 x 235 cm, 200 kg.

### COLOR

Yellow

Black

### OPTIONS

Coin / Token

Card Reader

Kindly take note that the measurements provided are approximate. The current models available may differ from the pictures exhibited. The color reproduction of images may differ from reality. Therefore, we encourage you to confirm the particularities of the product of your interest.

## Mini Tower Crane

**Measurement:**

129 (l) x 80 (w) platform x 247 (h) cm

**Weight:**

155 kg  
(excluding pit and blocks)

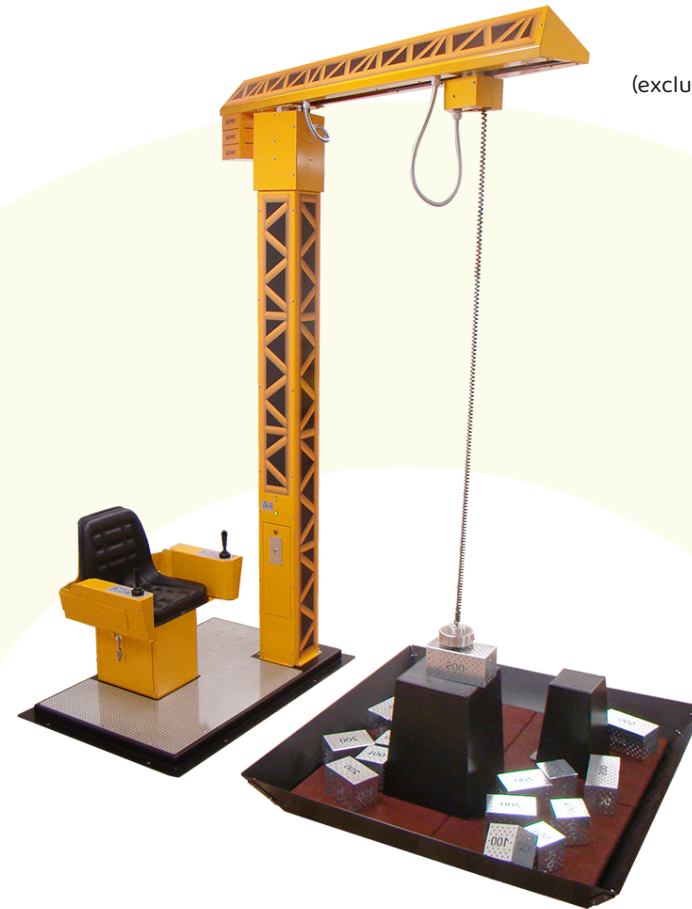

# TURNKEY FOR CONSTRUCTION ZONE

## SBI CAGE SYSTEM

Durable metal frame with welded wires. Powder coated, in Grey and Yellow.  
Zinc treated when for outdoor use.  
Modular system. Customizable to fit your location perfectly. Many theming options possible.

**Introducing a Turnkey Solution for Your Construction Zone – a versatile modular system that blends the ease of a ready-made package with the creative freedom of customization.**

**Our scalable and themed fence system ensures a safe and carefully designed attraction from start to finish. If you wish to make the attraction more appealing you can mix mini diggers, mini grabbers and mini tower cranes.**

For construction zone-themed attractions, having a fence around the active work area is not just a safety requirement; it's also essential for creating an immersive experience. We now offer a comprehensive package that can be tailored to your specific needs, whether you require one unit or several. Our package includes wall panels, poles, maintenance doors, and thematic signage.

This turnkey attraction setup, with its customizable elements, is ideal for indoor venues, but it's equally suitable for outdoor use. By combining a well-structured pre-packaged solution with the flexibility to customize, our aim is to provide customers with the perfect balance between convenience and creativity. Ultimately, our goal is to deliver exceptional value to visitors while ensuring safety and an immersive experience.



# CREATE YOUR PERFECT CONSTRUCTION ZONE

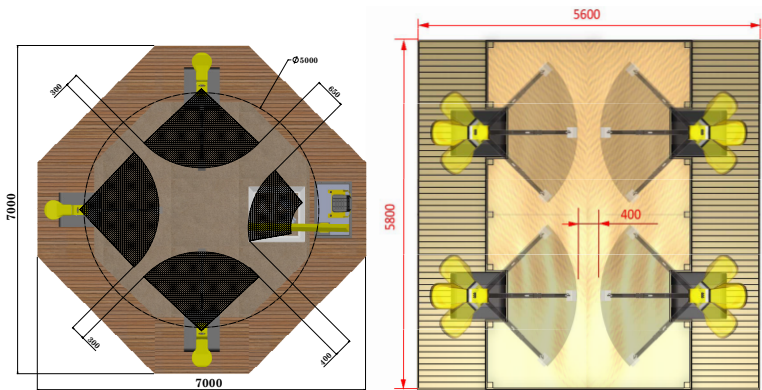
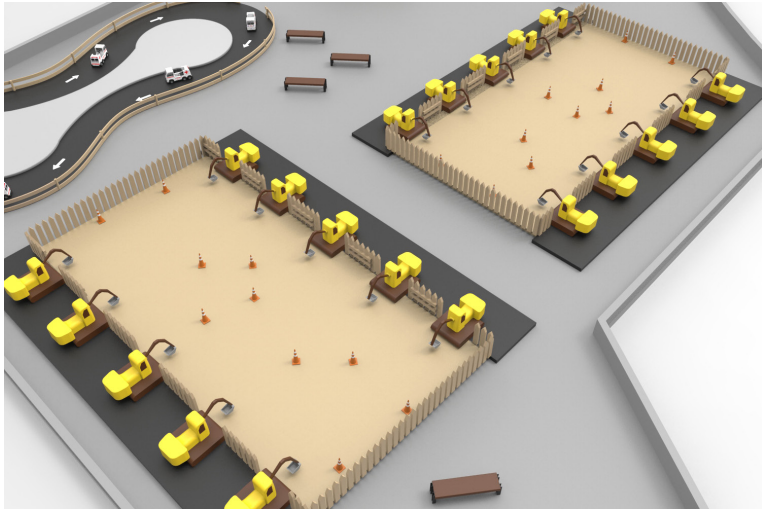

4 units - Setup A



1 unit

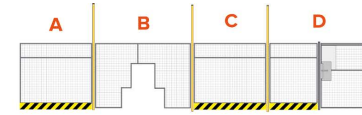
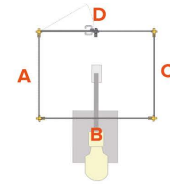

2 units

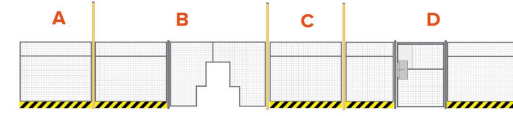
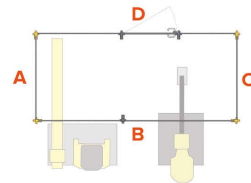

3 units

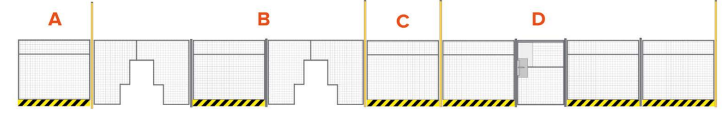
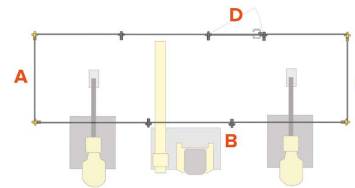

4 units

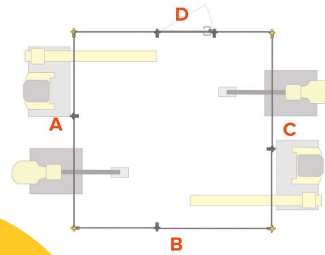

# Kiki

## KIKI WALL



Kiki Wall was designed for children between 3 and 12 years of age and offers a group of educational and creative games/applications where children can draw, learn numbers, letters and words in foreign languages, play instruments or perform many other interesting activities, some of which together with their friends.

Due to its small overall dimensions, Kiki Wall can easily find its space in almost all rooms and helps you keep your visitors happy and satisfied.

Weight	33,5 kg
Dimensions	77,5 (w) x 40 (d) x 120,5 (l) cm
Custom design	on request

20 programs

more designs

2 - 10 years

More information



## KIKI ARCADE



Kiki Arcade is the restyling of an arcade cabinet and can easily entertain all generations with such evergreen games as Pac-Man, Tetris, Street Fighter or Space Invaders.

Its retro design makes it fit for all environments. The kids will adore it and all the others will happily play their favorite, well known games.

Weight	40 kg
Dimensions	58 (w) x 67 (d) x 136 (h) cm
Custom design	on request

20 programs

1200 games

3+ years

More information



## STOLNÝ FUTBAL



Kiki Soccer is the traditional table football game, designed for complete safety of the playing children.

Among its features you will find the non-removable balls, the field covered by a tempered safety glass and the telescopic rods to avoid injuries.



Weight	45 kg
Dimensions	80 (w) x 52,5 (d) x 84 (h) cm
Custom design	on request

2 players

kids size

3 - 10 years

More information

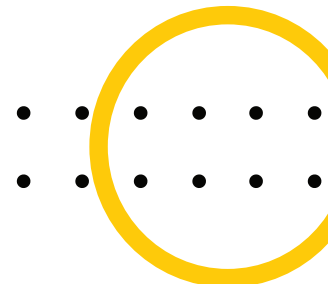

## Contact



**botond@fairytalehouses.eu**  
**+421 905 407 382**  
**www.fairytalehouses.eu**

